

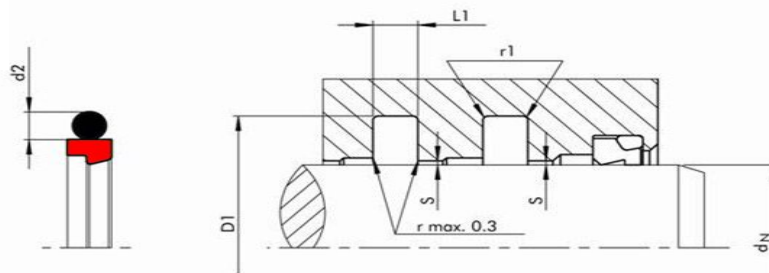

上海瑞密机械有限公司 SHANGHAI RUIMI MACHINERY CO.,LTD

轴用斯特封Slide Ring for Rods-GSJ



适用范围 Application Range				
	压力 Pressure [MPa]	温度 Temperature [° C]	速度 Sliding speed[m/s]	介质 Medium
标准产品 Standard	60	-45 至 200° C	15	液压油、阻燃液、水、气 Mineral oil based hydraulic fluids, barely flammable hydraulic fluids, water, air and others.

材料 Material		
	0 圈 O ring	滑环 slide ring
标准设计 Standard	NBR	PTFE-Bronze PTFE-青铜
特殊 Special (on	NBR	PTFE PTFE-carbon 碳纤维

设计标准或互换 Standard and/or can fit the groove
ISO 7425/2
GB-T 15242.3
RS13/RS11/RS15.GS55013/11/15

描述: 液压往复运动系统。在高、中、低压及重载，高频工况下的密封场合非常出色。适合各种行程及范围较广的流体和高温场合，可适用较大的活塞杆间隙。

例如用在推土机，挖掘机，锻压机，陶瓷压砖机，轧钢机，伺服阀及机床等。

符合GB/T 15242.1-94及GB/T 15242.3-94标准。可参考Parker公司OD系列、Merkel公司OMS-MR、Trelleborg公司RS1系列、AS公司的XB系列标准。

特点:

- > 良好的动静密封性能
- > 抗挤出性好
- > 尺寸稳定，不受温度影响
- > 不会发生困压，可多只串联安装
- > 对强冲击压力有优异的缓冲作用
- > 摩擦力小，无爬行，粘滞现象
- > 耐腐蚀性强
- > 沟槽结构简单
- > 寿命长
- > 有无润滑均可工作
- > 安装简便

安装尺寸:

轴径 d_n h9			沟槽外径	沟槽宽度	圆角	径向间隙 S max			O型圈截面
标准规格	轻型	重型	D_1 H9	$L_1+0.2$	r_1	10 Mpa	20 Mpa	40 Mpa	d_2
3-7.9	8-18.9	—	$d+4.9$	2.2	0.4	0.3	0.20	0.15	1.78
8-18.9	19-37.9	—	$d+7.3$	3.2	0.6	0.4	0.25	0.15	2.62
19-37.9	38-199.9	8-18.9	$d+10.7$	4.2	1	0.4	0.25	0.20	3.53
38-199.9	200-255.9	19-37.9	$d+15.1$	6.3	1.3	0.5	0.30	0.20	5.33
200-255.9	256-649.9	38-199.9	$d+20.5$	8.1	1.8	0.6	0.35	0.25	7.00
256-649.9	650-999.9	200-255.9	$d+24.0$	8.1	1.8	0.6	0.35	0.25	7.00
650-999.9	≥ 1000.0	256-649.9	$d+27.3$	9.5	2.5	0.7	0.50	0.30	8.40
≥ 1000.0	—	650-999.9	$d+38.0$	13.8	3	1.0	0.70	0.60	12.00

订货范例 Order Example for standard version:

轴径 Diameter $d = 100$ mm **GSJ1000**

产品订货号	轴径	底径	宽度
	d_n h9	D_1 H9	$L_1+0.2$
GSJ0040	4	8.9	2.2
GSJ0050	5	9.9	2.2
GSJ0060	6	10.9	2.2
GSJ0080L	8	12.9	2.2
GSJ0080	8	15.5	3.2
GSJ0100L	10	14.9	2.2

产品订货号	轴径	底径	宽度
	d_n h9	D_1 H9	$L_1+0.2$
GSJ0100	10	17.3	3.2
GSJ0120L	12	16.9	2.2
GSJ0120	12	19.3	3.2
GSJ0140L	14	18.9	2.2
GSJ0140	14	21.3	3.2
GSJ0150L	15	19.9	2.2

如欲了解更详细内容，请与我方联系。For further information, please contact us.

www.ruimi.com.cn

轴用斯特封Slide Ring for Rods-GSJ

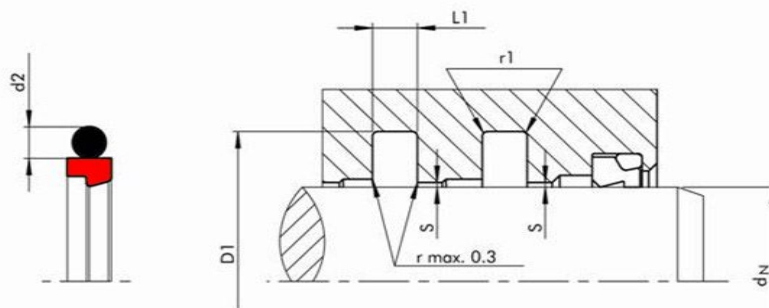

产品订货号	轴径	底径	宽度
	dn h9	D1 H9	L1+0.2
GSJ0150	15	22.3	3.2
GSJ0160L	16	20.9	2.2
GSJ0160	16	23.3	3.2
GSJ0180L	18	22.9	2.2
GSJ0180	18	25.3	3.2
GSJ0190	19	29.7	4.2
GSJ0200L	20	27.3	3.2
GSJ0200	20	30.7	4.2
GSJ0220L	22	29.3	3.2
GSJ0220	22	32.7	4.2
GSJ0250L	25	32.3	3.2
GSJ0250	25	35.7	4.2
GSJ0280	28	38.7	4.2
GSJ0300	30	40.7	4.2
GSJ0320	32	42.7	4.2
GSJ0350	35	45.7	4.2
GSJ0360	36	46.7	4.2
GSJ0380	38	53.1	6.3
GSJ0400L	40	50.7	4.2
GSJ0400	40	55.1	6.3
GSJ0420	42	57.1	6.3
GSJ0450L	45	55.7	4.2
GSJ0450	45	60.1	6.3
GSJ0500L	50	60.7	4.2
GSJ0500	50	65.1	6.3
GSJ0550	55	70.1	6.3
GSJ0560L	56	66.7	4.2
GSJ0560	56	71.1	6.3
GSJ0560H	56	76.5	8.1
GSJ0600	60	75.1	6.3
GSJ0630L	63	73.7	4.2
GSJ0630	63	78.1	6.3
GSJ0650L	65	75.7	4.2
GSJ0650	65	80.1	6.3
GSJ0700L	70	80.7	4.2
GSJ0700	70	85.1	6.3
GSJ0700H	70	90.5	8.1
GSJ0750L	75	85.7	4.2
GSJ0750	75	90.1	6.3
GSJ0800L	80	90.7	4.2
GSJ0800	80	95.1	6.3
GSJ0800H	80	100.5	8.1
GSJ0850L	85	95.7	4.2
GSJ0850	85	100.1	6.3
GSJ0850H	85	105.5	8.1
GSJ0900L	90	100.7	4.2
GSJ0900	90	105.1	6.3
GSJ0900H	90	110.5	8.1

产品订货号	轴径	底径	宽度
	dn h9	D1 H9	L1+0.2
GSJ0700	70	85.1	6.3
GSJ0700H	70	90.5	8.1
GSJ0750L	75	85.7	4.2
GSJ0750	75	90.1	6.3
GSJ0800L	80	90.7	4.2
GSJ0800	80	95.1	6.3
GSJ0800H	80	100.5	8.1
GSJ0850L	85	95.7	4.2
GSJ0850	85	100.1	6.3
GSJ0850H	85	105.5	8.1
GSJ0900L	90	100.7	4.2
GSJ0900	90	105.1	6.3
GSJ0900H	90	110.5	8.1
GSJ9500L	95	105.7	4.2
GSJ0950	95	110.1	6.3
GSJ1000L	100	110.7	4.2
GSJ1000	100	115.1	6.3
GSJ1000H	100	120.5	8.1
GSJ1050	105	120.1	6.3
GSJ1050H	105	125.5	8.1
GSJ1100L	110	120.7	4.2
GSJ1100	110	125.1	6.3
GSJ1100H	110	130.5	8.1
GSJ1150	115	130.1	6.3
GSJ1200	120	135.1	6.3
GSJ1200H	120	145.5	8.1
GSJ1250	125	140.1	6.3
GSJ1250H	125	145.5	8.1
GSJ1300	130	145.1	6.3
GSJ1400L	140	150.7	4.2
GSJ1400	140	155.1	6.3
GSJ1400H	140	160.5	8.1
GSJ1450	145	160.1	6.3
GSJ1450H	145	165.5	8.1
GSJ1500	150	165.1	6.3
GSJ1500H	150	170.5	8.1
GSJ1600	160	175.1	6.3
GSJ1600H	160	180.5	8.1
GSJ1650	165	180.1	6.3
GSJ1700	170	185.1	6.3
GSJ1700H	170	190.5	8.1
GSJ1800	180	195.1	6.3
GSJ1800H	180	200.5	8.1
GSJ1900	190	205.1	6.3
GSJ2000L	200	215.1	6.3
GSJ2000	200	220.5	8.1
GSJ2100	210	231.5	8.1
GSJ2200	220	240.5	8.1

轴用斯特封Slide Ring for Rods-GSJ

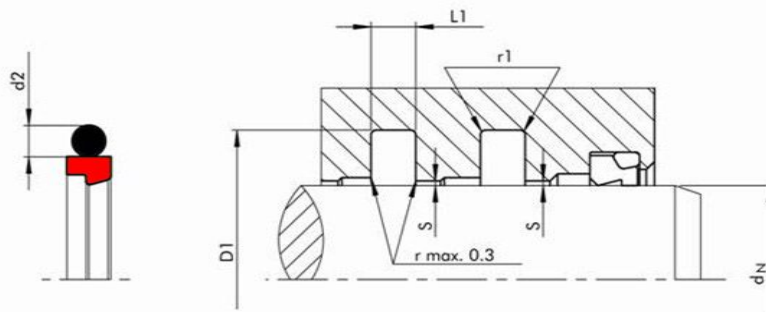

产品订货号	轴径	底径	宽度
	dn h9	D1 H9	L1+0.2
GSJ2300L	230	245.1	6.3
GSJ2300	230	250.5	8.1
GSJ2400	240	260.5	8.1
GSJ2500	250	270.5	8.1
GSJ2560	256	280.0	8.1
GSJ2600	260	284.0	8.1
GSJ2700	270	294.0	8.1
GSJ2800	280	304.0	8.1
GSJ2900	290	314.0	8.1
GSJ3000	300	324.0	8.1
GSJ3200	320	244.0	8.1
GSJ3300	330	354.0	8.1
GSJ3400	340	364.0	8.1
GSJ3500	350	374.0	8.1
GSJ3600	360	384.0	8.1
GSJ3700	370	394.0	8.1
GSJ3800	380	404.0	8.1
GSJ3900	390	414.0	8.1
GSJ4000	400	424.0	8.1
GSJ4100	410	434.0	8.1
GSJ4200	420	444.0	8.1
GSJ4300	430	454.0	8.1
GSJ4400	440	464.0	8.1
GSJ4500	450	474.0	8.1
GSJ4600	460	484.0	8.1
GSJ4800	480	504.0	8.1
GSJ4900	490	514.0	8.1
GSJ5000	500	524.0	8.1
GSJ5200	520	544.0	8.1
GSJ5400	540	564.0	8.1
GSJ5500	550	574.0	8.1
GSJ5800	580	604.0	8.1
GSJ6000	600	624.0	8.1
GSJ6200	620	644.0	8.1
GSJ6300	630	654.0	8.1
GSJ6400	640	664.0	8.1
GSJ6500	650	677.3	9.5
GSJ6600	660	687.3	9.5

产品订货号	轴径	底径	宽度
	dn h9	D1 H9	L1+0.2
GSJ6800	680.0	707.3	9.5
GSJ6850	685.0	712.3	9.5
GSJ7000L	700.0	724.0	8.1
GSJ7000	700.0	727.3	9.5
GSJ7100	710.0	737.3	9.5
GSJ7300	730.0	757.3	9.5
GSJ7500	750.0	777.3	9.5
GSJ7600	760	787.3	9.5
GSJ7800	780	807.3	9.5
GSJ7900	790	817.3	9.5
GSJ8000	800	827.3	9.5
GSJ8100	810	837.3	9.5
GSJ8200	820	847.3	9.5
GSJ8300	830	857.3	9.5
GSJ8500	850	877.3	9.5
GSJ8700	870.0	897.3	9.5
GSJ8800	880.0	907.3	9.5
GSJ8850	885.0	912.3	9.5
GSJ8900	890.0	917.3	9.5
GSJ9000	900.0	927.3	9.5
GSJ9300	930.0	957.3	9.5
GSJ9500	950	977.3	9.5
GSJ10000L	1000	1027.3	9.5
GSJ10000	1000	1038.0	13.8
GSJ10350	1035	1073.0	13.8
GSJ10400L	1040	1067.3	9.5
GSJ10400	1040	1078.0	13.8
GSJ10500L	1050	1077.3	9.5
GSJ10500	1050	1088.0	13.8
GSJ11000	1100.0	1138.0	13.8
GSJ11200L	1120.0	1147.3	9.5
GSJ11200	1120.0	1158.0	13.8
GSJ12000L	1200.0	1227.3	9.5
GSJ12000	1200.0	1238.0	13.8
GSJ13300L	1330.0	1357.3	9.5
GSJ13300	1330	1368.0	13.8
GSJ15000L	1500	1527.3	9.5
GSJ15000	1500	1538.0	13.8